

CLEANOUT TO GRADE (COTG)

WALL CLEANOUT (WCO)

CLEAN OUT DETAILS

NO SCALE

WET RISER DETAIL NOTES

- 1 WATER SUPPLY FROM CITY WATER MAIN. USE CLASS 53 DUCTILE IRON WHEN CROSSING UNDER BLDG FOUNDATION.
- 2 USE FLEXIBLE GROOVED PIPE COUPLING ONLY IF SEISMIC BRACING IS REQUIRED. SEE NOTE #12.
- 3 GROOVED BUTTERFLY VALVE WITH INTEGRAL SUPERVISORY SWITCH.
- 4 DOUBLE CHECK BACKFLOW PREVENTER WITH RELATED TRIM AND GAUGES.
- 5 3-1/2" DIAMETER WATER GAUGE WITH 1/4" TEST AND ISOLATION VALVE.
- 6 VANE TYPE WATER FLOW SWITCH.
- 7 SUPPLY TO WET PIPE FIRE SPRINKLER SYSTEM.
- 8 SWING CHECK VALVE.
- 9 RISER MANIFOLD - INCLUDES PRESURE GAUGE, FLOW SWITCH, PRESSURE RELIEF VALVE, AND TEST AND MAIN DRAIN DEVICE.
- 10 INSPECTOR'S TEST & MAIN DRAIN DEVICE IT PIPE TO OUTSIDE.
- 11 PRESSURE RELIEF VALVE SHALL BE REQUIRED SET AT ITS PSI - PIPED TO DISCHARGE OUTSIDE.
- 12 SEISMIC BRACING REQUIRED IN SEISMIC DESIGN CATEGORY C, D, E, F.
- 13 1/2" AUTOMATIC BALL DRIP VALVE.
- 14 PIPE TO DRAIN OUTSIDE.
- 15 WEATHERPROOF ELECTRIC BELL OR HORN AND STROBE (OUTSIDE).
- 16 OUT TO FIRE DEPARTMENT CONNECTION WITH GALVANIZED SCH 40 PIPING- PROVIDE BALL DRIP WHEN TRAPPING PIPE. SIZE CONNECTION AS REQUIRED. NOTE: PIPE FDC TO REMOTE LOCATION ON STAKE BUILDINGS AND WHEN REQUIRED BY FIRE MARSHAL.
- 17 GALVANIZED FLANGE AND SPOOL PIECE
- 18 CLASS 53 D.I. FLANGED SPIGOT
- 19 3/4" A.T.R.
- 20 3/4" BENT EYE BOLT
- 21 MECHANICAL JOINT 90° ELL
- 22 CONCRETE THRUST BLOCK WITH 5 SQ. FEET BEARING AREA
- 23 UNDISTURBED EARTH
- 24 LOW TEMPERATURE SENSOR - MOUNTED ON WALL - THIS SWITCH IS PROVIDED UNDER DIVISION 28 OF THE SPECIFICATIONS.
- 25 SPARE HEAD CABINET WITH SPARE SPRINKLER HEADS AND WRENCHES.
- 26 LAMINATED SYSTEM MAP WITH SYSTEM START-UP AND SHUT-DOWN INSTRUCTIONS.

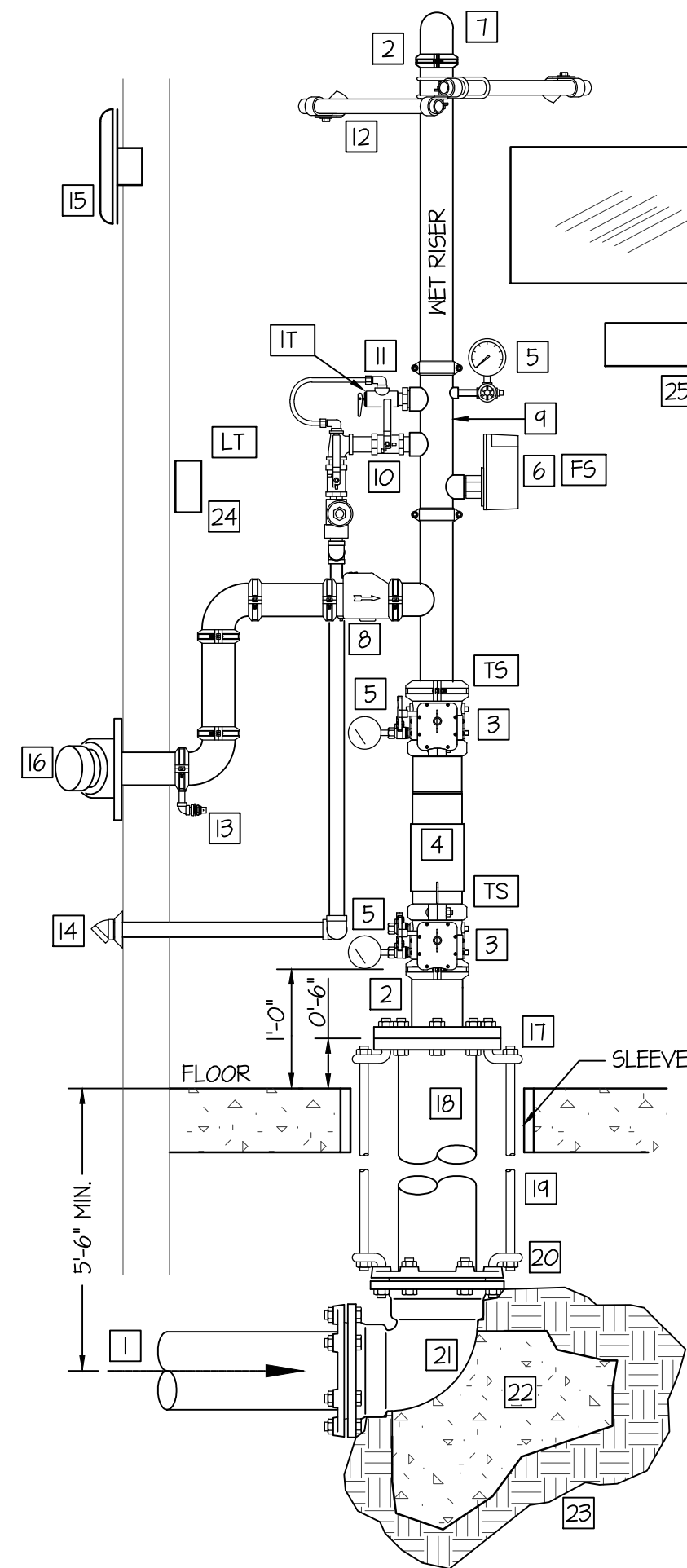

NOTE:
PROVIDE SLEEVES WHERE PIPING PENETRATES BUILDING AT FLOOR AND WALLS. SEAL AROUND PENETRATION WITH FLEXIBLE MASTIC AT FLOOR. PROVIDE 2" ANNUAL SPACE AROUND AND RESTRAIN FLANGE SPIGOT.

VERTICAL FIRE RISER DETAIL

NO SCALE

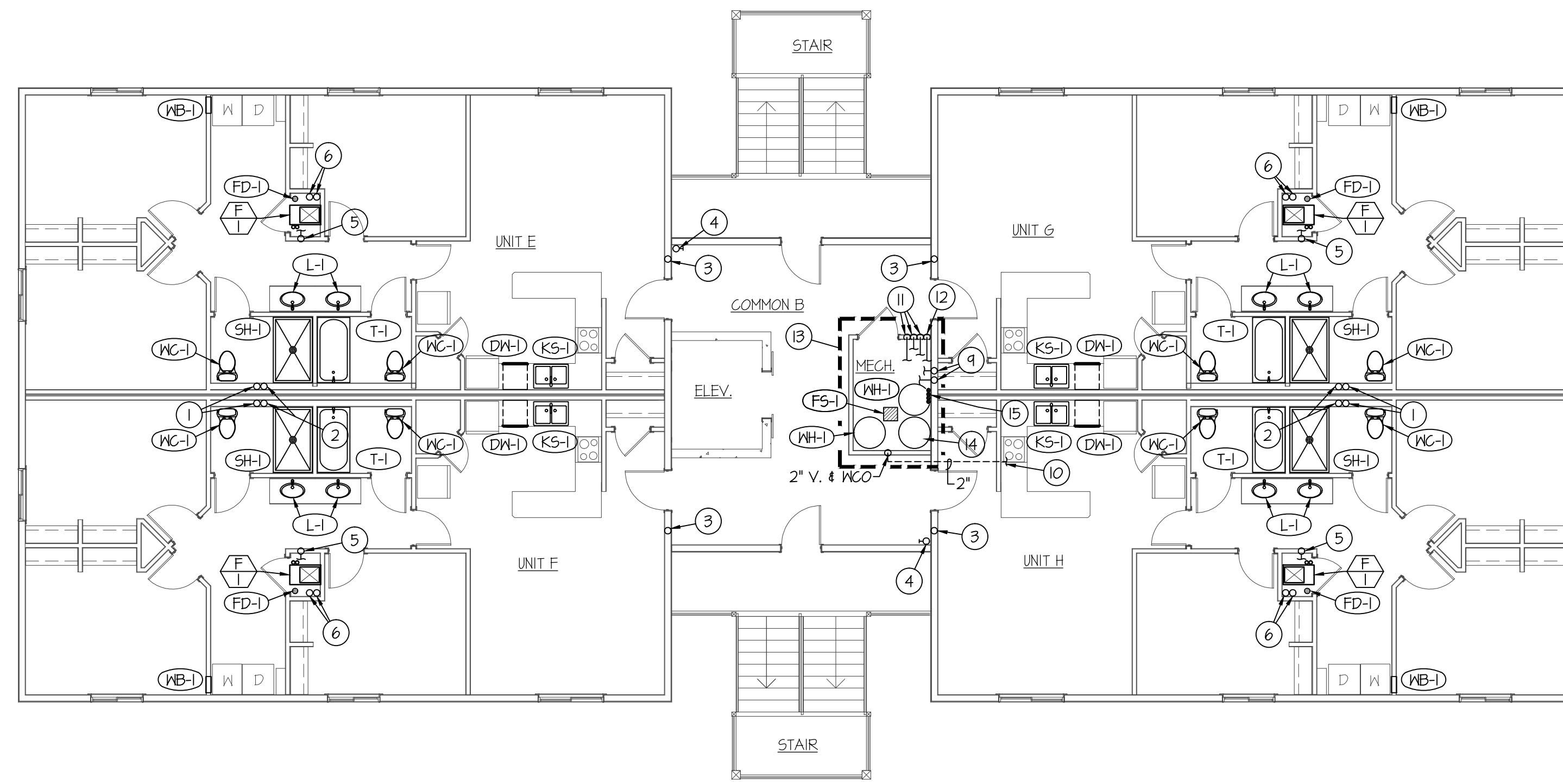

1ST LEVEL PLUMBING PLAN

SCALE: 1/8" = 1'-0"

SPECIAL NOTE:

SEE LARGE SCALE PLANS ON SHEET P-4 FOR TYPICAL WASTE, VENT, GAS AND WATER PIPING LAY-OUT FOR INDIVIDUAL APARTMENT TYPES.

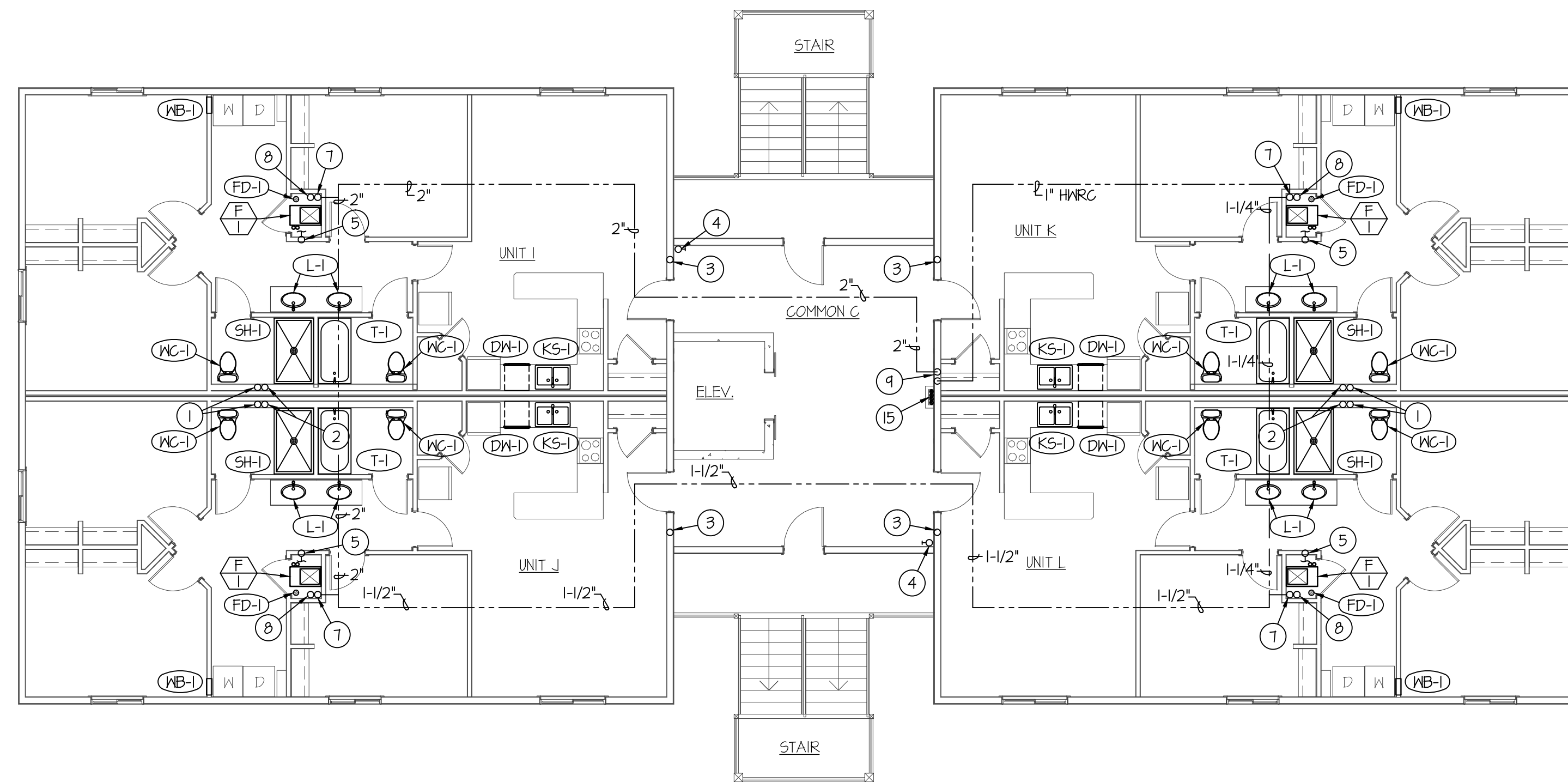

2ND LEVEL PLUMBING PLAN

SCALE: 1/8" = 1'-0"

PLAN NOTES:

- 1 4" WASTE STACK UP IN WALL ABOVE. SEE ALSO TYPICAL WASTE & VENT PIPING PLANS ON SHEET P-4.
- 2 4" VENT STACK UP IN WALL ABOVE. SEE SHEET P-3 FOR CONTINUATION OF PIPING. SEE ALSO TYPICAL WASTE & VENT PIPING PLANS ON SHEET P-4.
- 3 3" ROOF DRAIN LINE DOWN FROM ABOVE. SEE SHEET P-3 FOR ROOF DRAIN AND OVERFLOW DRAIN PIPING AND LOCATIONS ABOVE. SEE SHEET P-1 FOR ROOF DRAIN PIPING LOCATED UNDERSLAB.
- 4 4" FIRE LINE STANDPIPE UP FROM BELOW. INSTALL 2-1/2" FIRE HOSE CONNECTION AT EACH LEVEL. CONNECTION TO BE 36" ABOVE FINISHED FLOOR.
- 5 RISE 3/4" (2 PSI) GAS LINE UP IN WALL TO SERVE ALL LEVELS OF APTS. SEE LARGE SCALE PLANS ON SHEET P-4 FOR CONNECTION TO FURNACES.
- 6 1" HW UP FROM BELOW TO SERVE THIS APT AND 1-1/2" CW UP FROM BELOW TO SERVE THIS APT AND 2 LEVELS ABOVE. SEE LARGE SCALE PLANS ON SHEET P-4 FOR PIPING LOCATED IN INDIVIDUAL APTS.
- 7 1-1/4" HW PIPING TO SERVE APT. ON THIS LEVEL AND LEVEL 3 APT ABOVE.
- 8 1-1/4" CW UP FROM BELOW TO SERVE THIS APT AND LEVEL 3 APT. ABOVE. SEE LARGE SCALE PLANS ON SHEET P-4 FOR PIPING LOCATED IN INDIVIDUAL APTS.
- 9 DROP 2" HW AND 1" HWRC DOWN IN WALL TO MECHANICAL ROOM ON LEVEL 1 BELOW.
- 10 CONNECT 2" VENT SERVING FLOOR SINK IN MECH. ROOM TO ADJACENT APT. VENT PIPING SYSTEM CONNECTING TO 4" VENT STACK.
- 11 DROP 2" HW, 2" CW AND 3/4" HWRC PIPING DN. IN WALL TO SERVE GROUND LEVEL AND 1ST LEVEL APTS.
- 12 DROP 3/4" (2 PSI) GAS LINE UP IN WALL TO GROUND LEVEL CEILING SPACE BELOW. SEE SHEET P-1 FOR CONT. OF PIPING.
- 13 SEE LARGE SCALE MECH. ROOM PLUMBING PLAN ON SHEET P-4 FOR WATER HEATER PIPING AND FLUES LOCATED IN THIS AREA.
- 14 125 GALLON HOT WATER STORAGE TANK, SEE WATER HEATER PIPING DIAGRAM ON SHEET P-3.
- 15 RISE (4) 3" WATER HEATER FLUES UP IN CHASE THRU ALL LEVELS ABOVE 1ST LEVEL THRU ROOF TO (2) VERTICAL VENT TERMINATION ASSEMBLIES.



Engineered Systems Associates
Mechanical Engineers

Dwayne Sudweeks
1355 East Center - Pocatello, Idaho 83201
Phone: (208) 233-0501 Fax: (208) 233-0529 email: esa@engsystems.com

SAVOYE APARTMENTS
REXBURG, IDAHO

1ST AND 2ND LEVEL PLUMBING PLANS

PROJECT:

SHEET TITLE:

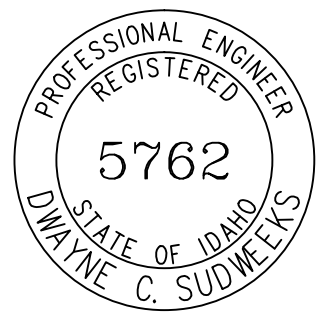

| | |
|-----------|----------|
| DRWN. BY: | CKD. BY: |
| SR | DCS |
| JOB NO. | DATE: |
| 17035 | MAY 2017 |

ORIGINAL DRAWING SIGNED BY: DWAYNE C. SUDWEKS
DATE ORIGINAL SIGNED: MAY 5, 2017
ORIGINAL ON FILE AT ENGINEERED SYSTEMS ASSOCIATES
1355 EAST CENTER, POCATELLO, IDAHO 83201

SHEET:

P-2
OF: FOUR